

UN1800A5 Specifications

18471/18000

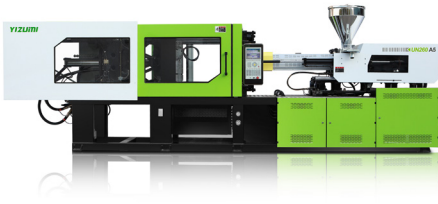

FEATURES

- World famous Austrian made KEBA 1075 Microprocessor control
- Control of oil temperature from the Keba controller
- Oil level monitoring
- Injection hold changeover by time, distance or pressure
- Control of barrel throat temperature via the Keba controller
- Semi-auto start button on a flying lead with magnetic base
- European Linear transducers
- European seals
- European hydraulic valves
- European switchgear
- Back pressure controlled by proportional valve
- Water manifold with 6 circuits
- 2 x air-blast circuits with pneumatic valves fitted
- Double core pull
- Euomap 67 interface
- Ejector safety circuit
- Oil preheating circuit
- Servo motor energy saving pump system
- CE certification
- Anti-vibration mounts
- Spares package
- Tool kit & mould clamps
- 3 off auxillary three phase sockets

INJECTION UNIT

Screw designation		A	B	C
Shot volume	cm ³	10019	11559	13208.4
Shot weight	g	9217.5	10634.3	12151.7
	oz	325.1	375.1	427.9
Screw diameter	mm	135	145	155
Injection pressure	MPa	184.3	159.8	139.8
Injection rate	g/s	1151	1328	1517
Screw L:D ratio		23.6:1	22:1	20:1
Max. injection speed	mm/s	87.4		
Screw stroke	mm	700		
Screw speed (stepless)	r/min	0 - 117		

CLAMP UNIT

Clamping force	kN	18000		
Opening Stroke	mm	1560		
Space between tie bars	mm	1560 x 1560		
Max. Daylight	mm	3210		
Mould thickness (min-max)	mm	800 - 1650		
Ejector stroke	mm	400		
Ejector push rod number		33		
Ejector force	kN	303		

POWER UNIT

Hydraulic system pressure	MPa	17.5		
Pump motor	kW	55 x 3		
Heating capacity	kW	93.7		
Number of temp control zones		8		

GENERAL

Dry cycle time	s	13		
Oil tank capacity	L	1900		
Machine dimensions (LxWxH)	m	14.35 x 3.30 x 3.19		
Machine weight	kg	108000		

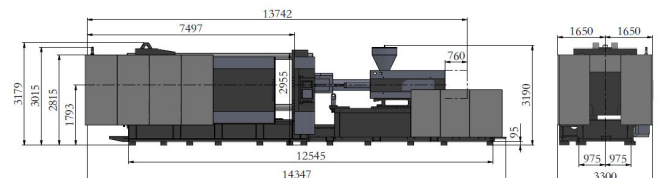
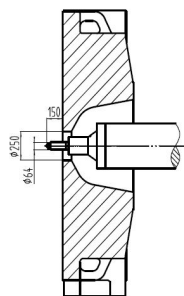
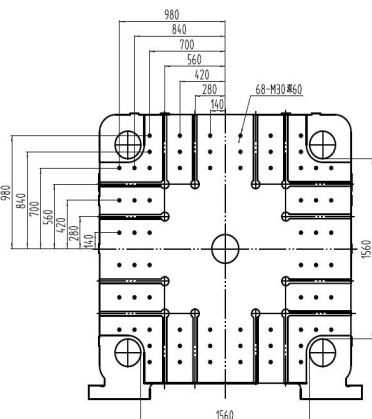

T形槽

