

UN1400A5 Specifications

12053/14000



FEATURES

- World famous Austrian made KEBA 1075 Microprocessor control
- Control of oil temperature from the Keba controller
- Oil level monitoring
- Injection hold changeover by time, distance or pressure
- Control of barrel throat temperature via the Keba controller
- Semi-auto start button on a flying lead with magnetic base
- European Linear transducers
- European seals
- European hydraulic valves
- European switchgear
- Back pressure controlled by proportional valve
- Water manifold with 6 circuits
- 2 x air-blast circuits with pneumatic valves fitted
- Double core pull
- Euomap 67 interface
- Ejector safety circuit
- Oil preheating circuit
- Servo motor energy saving pump system
- CE certification
- Anti-vibration mounts
- Spares package
- Tool kit & mould clamps
- 3 off auxillary three phase sockets

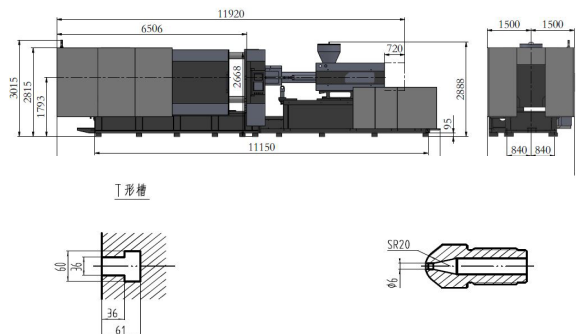
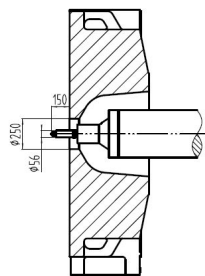
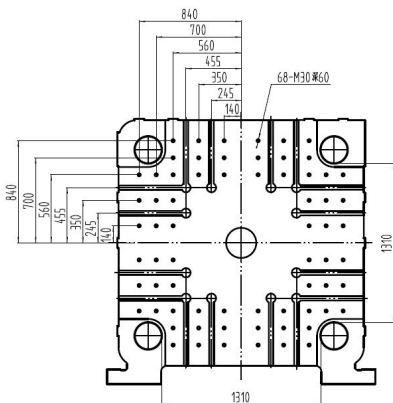

INJECTION UNIT

Screw designation		A	B	C
Shot volume	cm ³	6339.8	7363.1	8588.3
Shot weight	g	5832.6	6774.1	7901.3
	oz	205.7	238.9	278.2
Screw diameter	mm	116	125	135
Injection pressure	MPa	190.1	163.7	140.4
Injection rate	g/s	790	917	1070
Screw L:D ratio		22:1	20:1	20:1
Max. injection speed	mm/s	81		
Screw stroke	mm	600		
Screw speed (stepless)	r/min	0 - 106		

CLAMP UNIT

Clamping force	kN	14000		
Opening Stroke	mm	1350		
Space between tie bars	mm	1310 x 1310		
Max. Daylight	mm	2700		
Mould thickness (min-max)	mm	600 - 1350		
Ejector stroke	mm	380		
Ejector push rod number		29		
Ejector force	kN	303		

POWER UNIT

Hydraulic system pressure	MPa	17.5		
Pump motor	kW	60 x 2		
Heating capacity	kW	65.6 / 69.9		
Number of temp control zones		9.5		

GENERAL

Dry cycle time	s	13		
Oil tank capacity	L	1600		
Machine dimensions (LxWxH)	m	12.64 x 3.00 x 3.02		
Machine weight	kg	75000		